

Innovative Tracheotomy Products



The Shikani Speaking Valve™
One valve. Infinite possibilities.



The Shikani HME™
Breathe easily. Speak easily.

Smaller Smarter Smoother



The Shikani Speaking Valve™

One valve. Infinite possibilities.

The Shikani HME™

Breathe easily. Speak easily.



Unique Uniform Universal

The Shikani Speaking Valve™ is a patented two-way valve that offers decreased work of breathing and the ability to adapt the flow and closure characteristics to each patient's individual needs. Benefits include:

- Restored functional airway system
- Facilitated speech with enhanced naturalness
- Improved swallowing
- Improved olfaction
- Increased patient acceptance
- Reduced infections
- Managed secretions
- Reduced aspiration

The Shikani HME™ is a patented passive heat moisture exchange filter uniquely able to be used in conjunction with the Shikani Speaking Valve™ and also any industry standard 15mm cannula. Benefits of the Shikani HME™ include:

- More normalized temperature levels
- More normalized humidity levels
- More normalized pulmonary conditions
- Increased particulate filtration
- Increased secretion control
- Increased pulmonary health

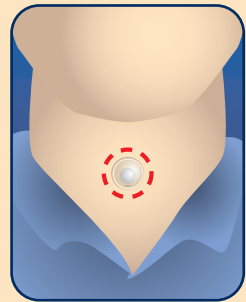

Smaller

The compact Shikani Speaking Valve™ was designed to be smaller and less conspicuous for daily use, offering a lower visual profile for the patient. The valve is available in Clear or Blue.

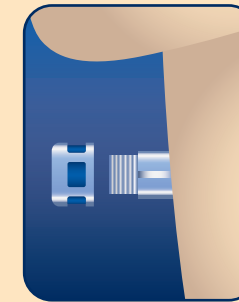

Unique

The Shikani HME™ was specifically designed to work with the Shikani Speaking Valve™ and this unique combination provides the established pulmonary benefits of HME use, with on-demand speech.

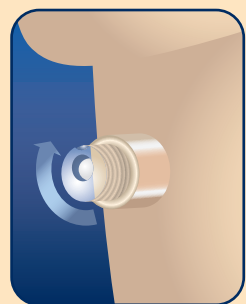

Smarter

The Shikani Speaking Valve™ features an adaptable design that allows patients and clinical professionals to easily control airflow and closure performance. By changing the valve's orientation on the inner cannula, tracheotomy patients can adjust the flow and closure characteristics to achieve their optimal breathing and speech setting.

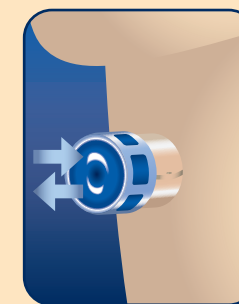

Uniform

The Shikani HME™ regulates heat and moisture levels for a more consistent and physiologically natural environment.

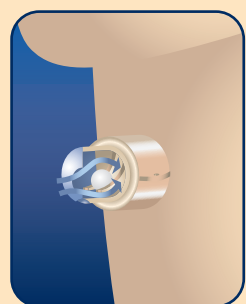

Smoother

The patented Shikani Speaking Valve™ utilizes a lightweight ball design which offers lower resistance during inhalation. This enables patients to inhale with greater ease, allowing for an improved overall breathing experience and subjectively better voice.

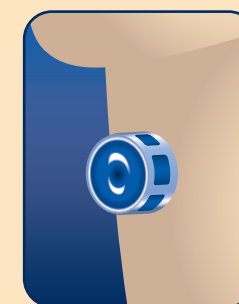

Universal

While designed specifically to work in unison with the Shikani Speaking Valve™, the Shikani HME™ also fits any standard 15mm tracheotomy tube cannula.

The complete line of Airway Company products



Shikani Speaking Valve™ - Clear

Clear Speaking Valve



Shikani HME™

Universal HME for use with the Shikani Speaking Valve™ or any industry standard 15mm Tracheotomy Tube cannula

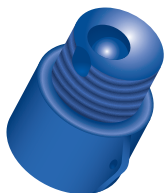

Shikani Speaking Valve™ - Blue

Blue Speaking Valve



Shikani Speaking Valve™ - Lanyard

SSV Lanyard



The
Airway Company
helping people breathe

1629 York Road, Lutherville, MD 21093

Tel 800.707.8458 Fax 877.707.7263

info@theairwaycompany.com

www.theairwaycompany.com

The Shikani Speaking Valve™ and Shikani HME™ are patented. This brochure and all product names, designs, images, and slogans are trademarks and/or copyrights of The Airway Company, a division of Shikani Medical, LLC. All rights reserved.