

Innovative Tracheotomy Products



The Shikani Speaking Valve™
Speak better.



The Shikani HME™
Breathe better.

Smaller Smarter Smoother



The Shikani Speaking Valve™
Speak better.

The Shikani HME™
Breathe better.



Unique Uniform Universal

The Shikani Speaking Valve™, based on a novel *ball* design, is the first true innovation in the field of tracheotomy speaking valves. Our ball valve offers many unique advantages, and patients can benefit from:

- Restored speech and airway system
- Increased comfort and valve tolerance
- Improved swallowing and coughing
- Easier initial valve acceptance and breathing
- Superior voice quality and olfaction
- The valve's ability to be used with an HME

The Shikani HME™ (Heat Moisture Exchanger), compatible with the Shikani Speaking Valve™, is a revolutionary device that helps tracheotomy patients restore their pulmonary health. Patients can benefit from:

- Normalized temperature and humidity levels
- Improved oxygenation via O₂ port
- Reduced risk of lung infection
- Increased particle filtration from inhaled air
- Better secretion control
- The HME's comfortability and small relative size

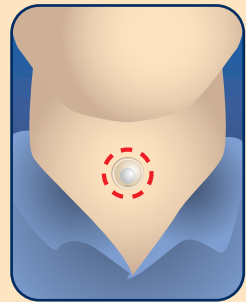

Smaller

The Shikani Speaking Valve™ was designed to be smaller than other valves, more comfortable, and more convenient for daily use.

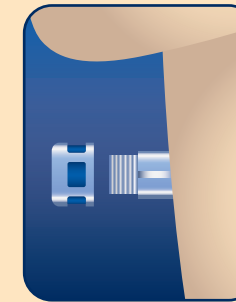

Unique

The Shikani HME™ was designed specifically to work in unison with the Shikani Speaking Valve™, and this unique combination provides the established pulmonary benefits of HME use, with on-demand speech.

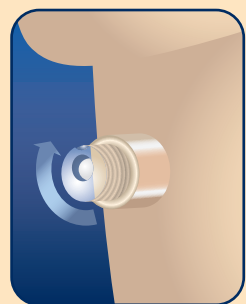

Smarter

The Shikani Speaking Valve™ features an adaptable design: by changing the valve's orientation, patients and clinicians can easily adjust airflow and closure characteristics to each patient's individual needs.

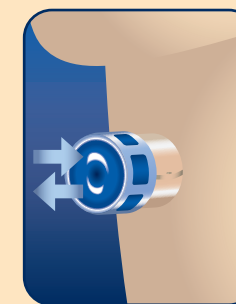

Uniform

The Shikani HME™ regulates heat and moisture levels in inhaled air, leading to a more consistent and physiologically-natural environment.

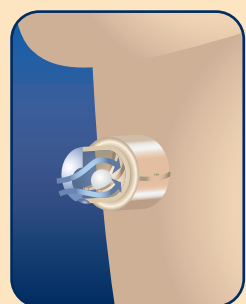

Smoother

The Shikani Speaking Valve™ utilizes a lightweight ball design which offers lower airflow resistance during inhalation and exhalation, allowing for an improved overall breathing and speaking experience.

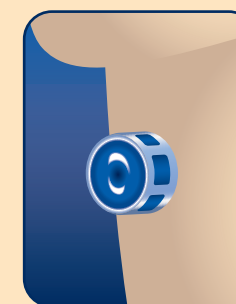

Universal

While designed to work with the Shikani Speaking Valve™, the Shikani HME™ also fits any standard 15mm tracheotomy tube cannula directly and can provide supplemental oxygen to the patient (if needed) via O₂ port.

The complete line of Airway Company products



Shikani Speaking Valve™ - Clear

Clear Speaking Valve
Product Code: SSV-C



Shikani HME™

Universal HME for use with the Shikani Speaking Valve™ or any industry standard 15mm Tracheotomy Tube cannula
Product Code: S-HME

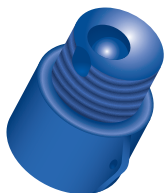

Shikani Speaking Valve™ - Blue

Blue Speaking Valve
Product Code: SSV-B



Shikani Speaking Valve™ - Lanyard

Product Code:
SSV-Lanyard



1629 York Road, Lutherville, MD 21093
Tel 800.707.8458 Fax 877.707.7263
info@theairwaycompany.com
www.theairwaycompany.com

The Shikani Speaking Valve™ and Shikani HME™ are patented. This brochure and all product names, designs, images, and slogans are trademarks and/or copyrights of The Airway Company. All rights reserved.